



living in motion



Technical data... Adria motorhomes

1 677 SP

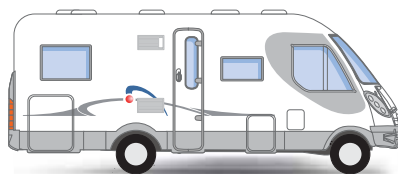

1 707 SG

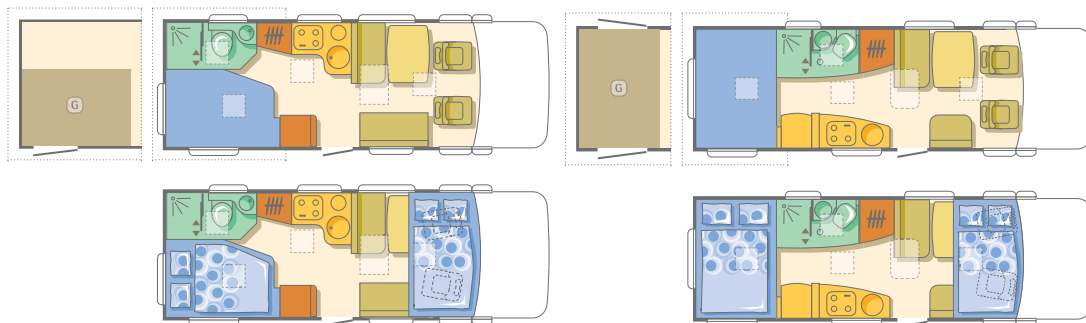
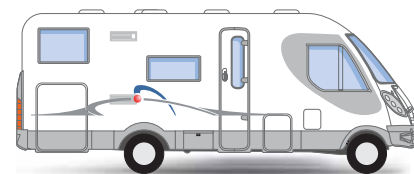

- standard
- o option
- not provided

	1 677 SP		1 707 SG	
BASIC DATA ABOUT VEHICLE				
Vehicle	Renault Master		Renault Master	
Motor	2,5 dCi 120	2,5 dCi 150	2,5 dCi 120	2,5 dCi 150
Volume; Kw / Km	2463 115/88	2463 146/107	2463 115/88	2463 146/107
Wheelbase	4.006		4.006	
Gears	6+R		6+R	
Drive	Front wheel		Front wheel	
Type dimentions	225/65 R16		225/65 R16	
Fuel tank (l)	100		100	
Battery (Ah)	95		95	
Homologated seats	3 (4)		2 (4)	
DIMENSIONS				
Overall Length.	6.95M		7.20M	
Overall Width.	2.29M		2.29M	
Overall Height.	2.96M		2.96M	
Internal Length.	5.05M		5.30M	
Internal Width.	2.18M		2.18M	
Internal Height.	2.04M		2.04M	
WEIGHT **				
Mass in running order.	3095 (3095) kg	3110kg (3110) kg	3175 (3175) kg	3190kg (3190) kg
Essential hab equip.	135 (162) kg	135 (162) kg	135 (162) kg	135 (162) kg
Max. user payload.	405 (755) kg	390 (740) kg	325 (675) kg	310 (660) kg
Max tech laden mass.	3500kg (3850kg)		3500kg (3850kg)	
SLEEPING AREA				
No. of berths	4		4	
Double bed.	2.20Mx1.30M		2.10Mx1.42M	
Lifting bed	1.98Mx1.50M		1.98Mx1.50M	

* alarm system with 2 volumetric sensors, 1 central unit, 2 remote control, 1 electric key, 1 Led and 1 siren with battery back up, 8x wireless sensors

** denotes estimated

***not included in the mass in running order

****100l for homologation 3.500kg, 130l for homologation 3.850kg

OPTIONS***

	(kg)	(kg)
● SE Pack - Blaupunkt Lucca Sat Nav, Fire retardent carpets, 5 year unlimited mileage warranty and an Adria Umbrella.		9
● Scooter holder for the garage-only for model 707 SG		9
● Additional heating Webasto		6,5
● Fire extinguisher		1
● Tow bar and electrics	45	
● Waste water omission tube		1,5
● Paintseal body protection	3	
● Additional WC cassette		2
● Air suspension AL - KO AMC - PREMIUM	12	
● Additional battery 85 Ah		30
● Ball coupling with holder, electrical connection	45	
● Alarm device - SICURA *		2
● Air condition in the cabin	18	
● Rear view camera	2,5	
● Radio CD, 4x15W RDS		3
● Wedges for wheels	1	
● Onboard computer		0,2
● Aluminium wheels	-10	
● Speed control - tempomat		1
● Navigation system	3	
● Gear box QUICK SHIFT (2,5 dCi 120)		8
● Windscreen - green part on top of the windscreen	0	
● Front fog lamps		4



vision

vision 1 707 SG

• standard o option – not provided

	1 677 SP	1 707 SG
EQUIPMENT		
NCC Inspected and approved motorhome	•	•
Thiefbeaters theft deterrent system	•	•
Blaupunkt San Remo radio / CD / MP3	•	•
Renault chassis cowl	•	•
Comfort cabin seats, turnable with integrated seats belt	•	•
Electric left window	•	•
El. heated and adjustable side mirrors	•	•
Double floor	•	•
Spare wheel***	• (26 kg)	• (26 kg)
Cabin lights	•	•
Corner steadies	•	•
Reverse driving sensor	•	•
Blaupunkt San Remo radio / CD / MP3	•	o
Front seats in original textile colour	•	•
Obscuration of the cabin	•	•
Seitz main entrance door	•	•
Seat belts - 3 points	4	4
Entrance step - electrical	•	•
Truma gas/electric hot water and heating	•	•
Luggage box	—	•
Luggage door	1x	2x
Luggage box heating	•	•
Gas bottle compartment	2 x 11 kg	2 x 11 kg
Roof light Midi Heki	1x	1x
Roof light Mini Heki	4x	4x
Elec. Lifting bed in the cabin with spring cushions and slatted frame	•	•
Ladder for the lifting bed	1x	2x
Spring cushions and slatted frame on fixed bed with el. lifting gear	•	•
Double glazed windows with blinds and flyscreens	•	•
KITCHEN UNIT		
Single lever faucet	•	•
Cooker (3 Flame) with glas covering	•	•
Extractor fan	•	•
Refrigerator AES 150 L with freezer and oven (tectower) - Dometic	•	•
Stainless steel sink	•	•
BATHROOM		
Waste water tank - heated (l)	110	110
Separated shower cubicle	•	•
Single lever shower faucet	•	•
Thetford CSW, turnable, electric pump, air system	•	•
Fresh water tank (l)****	100 (130)	100 (130)
ELECTRICAL SUPPLY		
Mains electric trip switch	•	•
Schaudt control pannel, digital	•	•
EBL 225 - SCHAUDT	•	•
Battery 85 Ah, K=20 (Ah)	•	•
Spot lights 12 V	•	•
Power sockets 12 V/220V	•	•
Awning light	•	•
Flat screen TV cabinet with, sockets 2 x 12 V, 230 V, antenna socket	•	•
Loudspeakers in the cabin 2x	•	•
Solar cells (preinstalations)	•	•
Sattelite dish (preinstalations)	•	•

- kitchen
- table
- sitting group
- wardrobe
- berths
- bathroom
- floor
- G garage box

A 697 SL

A 697 SG

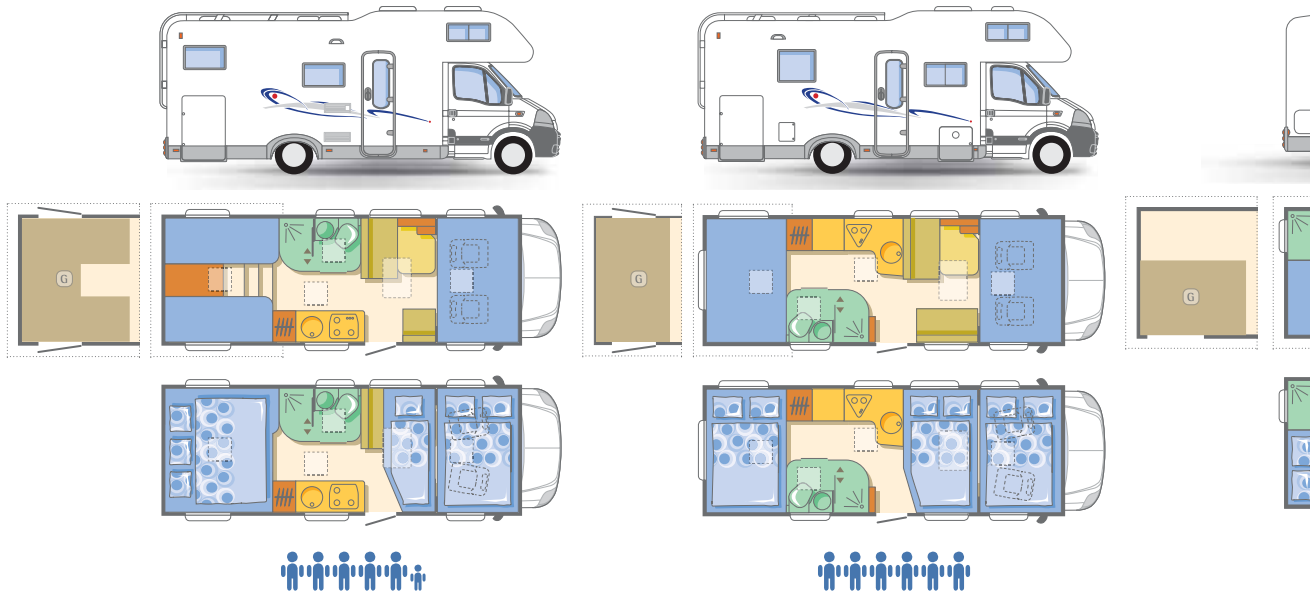

● standard ○ option – not provided

	A 697 SL		A 697 SG	
BASIC DATA ABOUT VEHICLE				
Vehicle	Renault Master		Renault Master	
Motor	2,5 dCi 120	2,5 dCi 150	2,5 dCi 120	2,5 dCi 150
Volume; HP / KW	2463 115/88	2463 146/107	2463 115/88	2463 146/107
Wheelbase.	4.078		4.078	
Gears	6 + R		6 + R	
Powered	Front wheel		Front wheel	
Tyre dimentions.	225/65 R16C		225/65 R16C	
Gas tank (l)	100		100	
Battery (Ah)	95		95	
Homologated seats **	3(4)		3 (4)	
DIMENSIONS				
Overall Length.	7.17M		7.17M	
Overall Width.	2.29M		2.29M	
Overall Height.	3.07M		3.07M	
Internal Length.	4.77M		4.77M	
Internal Width.	2.18M		2.18M	
Internal Height.	2.24M-2.09M		2.24M-2.09M	
WEIGHT **				
Mass in running order.	3075 (3075)kg	3090 (3090)kg	3090 (3090)kg	3105 (3105)kg
Essential hab equip.	144 kg	144 kg	144 kg	144 kg
Max. user payload.	425 (775) kg	410 (760) kg	410(760) kg	395(745) kg
Max tech laden mass.	3500 (3850)kg		3500 (3850)kg	
BODYWORK				
Thickness: walls/floor/roof (mm)	31/41/31		31/41/31	
Insulation: walls/floor/roof (mm)	25/30/25		25/30/25	
SLEEPING AREA				
No. of berths	5+1		6	
Over cab bed.	2.05Mx1.25M		2.05Mx1.25M	
Dinette bed.	2.10Mx1.30M-0.60M		2.10Mx1.25M-1.07M	
Double bed.	2.00M-1.90Mx0.83M		2.10Mx1.40M	

* alarm system with 2 volumetric sensors, 1 central unit, 2 remote control, 1 electric key, 1 Led and 1 siren with battery back up, 8x wireless sensors

** denotes estimated

***not included in the mass in running order

OPTIONS***

	(kg)	(kg)
● SE Pack - Blaupunkt Lucca Sat Nav, Fire retardent carpets, 5 year unlimited mileage warranty and an Adria Umbrella.		
● Tow bar and electrics	2	
● Paintseal body protection	45	
● DuPont Teflon fabric protection	50	
● Ball coupling with holder, el. conn.	3	
● Motorbike holder	45	
● Aluminium wheels	72	
● ALKO AIR TOP	-10	
● Rear view camera		2,5
● Alarm device - SICURA *		2
● Manual aircondition		18
● Radio CD, 4x15W RDS		3
● Onboard computer		0,2
● Speed control - tempomat		1
● Satellite navigation system with radio CD		3
● Gear box QUICK SHIFT (2,5 dCi 120)		8
● Front fog lamps		4

S 687 SP

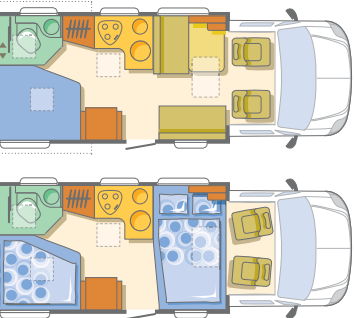

S 687 SPG

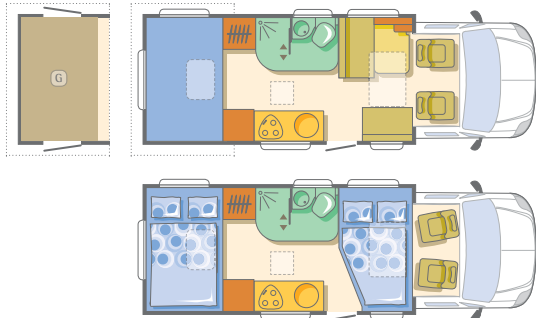

izola

S 687 SP		S 687 SPG	
Renault Master		Renault Master	
2,5 dCi 120	2,5 dCi 150	2,5 dCi 120	2,5 dCi 150
2463 115/88	2463 146/107	2463 115/88	2463 146/107
4.078		4.078	
6 + R		6 + R	
Front wheel		Front wheel	
225/65 R16C		225/65 R16C	
100		100	
95		95	
4		4	
6.87M		7.05M	
2.29M		2.29M	
2.69M		2.69M	
4.52M		4.73M	
2.18M		2.18M	
1.98M-1.85M		1.98M-1.85M	
2915 (2915)kg	2930(2930)kg	2970 (2970)kg	2985 (2985)kg
144 kg	144 kg	144 kg	144 kg
585(935) kg	570(920) kg	530 (880) kg	515 (865) kg
3500 (3850)kg		3500 (3850)kg	
31/41/31		31/41/31	
25/30/25		25/30/25	
4		3	
-		-	
2.11Mx1.34M		2.11Mx1.25M-0.88M	
1.95Mx1.30M-1.00M		2.11Mx1.34M	



izola S 687 SP



* alarm system with 2 volumetric sensors, 1 central unit, 2 remote control, 1 electric key, 1 Led and 1 siren with battery back up, 8x wireless sensors
 ** denotes estimated
 ***not included in the mass in running order

izola S 687 SP

• standard o option – not provided

	A 697 SL	A 697 SG
▶ STANDARD EQUIPMENT		
Chassis extension	•	•
Corner steadies	•	•
Awning light	•	•
Seitz windows with blinds and flyscreens	•	•
Seitz main entrance door	•	•
Roof light Heki III	–	–
Roof light 400 x 400 mm	1x	1x
Roof light Midi Heki	1x	1x
Roof light Mini Heki	3x	3x
Roof rack with ladder	•	•
Outside luggage box	•	•
Double floor	•	•
Refrigerator N150 L, SES	–	•
Refrigerator 104 L	•	–
3 burner stainless steel hob	•	•
Stainless steel sink	•	•
Extractor fan	•	•
Truma gas/electric hot water and heating	•	•
Ducted warm air to luggage spaces	•	•
Thetford CSW, turnable, electric pump	•	•
Separate shower cabin	•	•
Solid shower door	•	•
Fresh water tank capacity (l)	110	110
Waste water tank capacity (l)	95	95
Shower tray	•	•
Shower fowcet - separate	•	•
Control panel	•	•
Leisure battery	85	85
Spot lights	•	•
Luggage space lights	•	•
Wardrobe light	•	•
Seat belts 2 x 3 points	•	•
Cushion formed 120 mm	•	•
Spring cushion in bedroom	•	•
Flatscreen TV storage and holder	•	•
TV antenna socket with coax wiring	•	•
Front seats covering	•	•
Gas grill Smev 0555 VG	•	–
Gas oven Smev of 300	–	•
12 waste water heater	–	–
12 v waste water valve heater	•	•
Calori travel heater	•	•
Satellite dish (preinstalations)	•	•
Solar cells (preinstalations)	•	•
Air con. living space (preinstalations)	•	•
Rear view camera (preinstalations)	•	•

- kitchen
- table
- sitting group
- wardrobe
- berths
- bathroom
- floor
- G garage box

A 640 SK

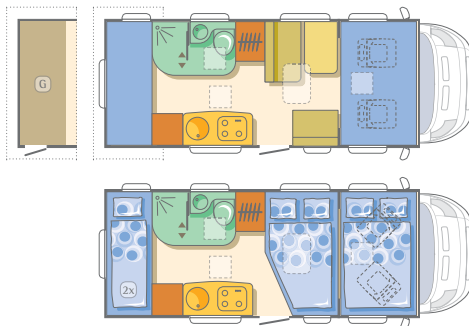

A 660 SP

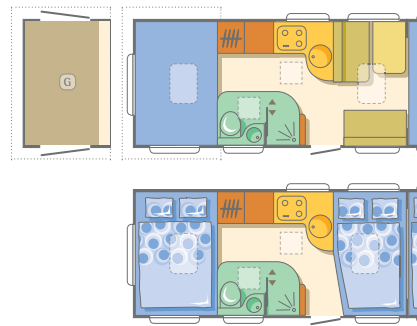
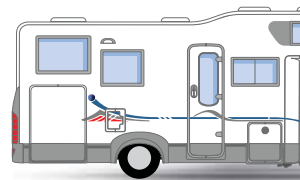

• standard o option – not provided

BASIC DATA ABOUT VEHICLE

	A 640 SK		A 660 SP	
Vehicle	FIAT Ducato			
Motor	130 JTD (2,3)-35L	160 JTD (3,0)-35L	130 JTD (2,3)-35L	160 JTD (3,0)-35L
Volume; HP / KW	2287 130/95,5	2999 157/115,5	2287 130/95,5	2999 157/115,5
Wheelbase	3.800		4.035	
Gears	6+RM		6+RM	
Drive	Front Wheel		Front Wheel	
Tyre dimensions	215/70 R15		215/70 R15	215/70 R15
Fuel tank (l)	60		60	
Battery (Ah)	95		95	
Homologated seats	4	3	4	3

DIMENSIONS

Overall Length.	6.61M	7.31M
Overall Width.	2.29M	2.29M
Overall Height.	3.12M	3.10M
Internal Length.	4.08M	4.78M
Internal Width.	2.18M	2.18M
Internal Height.	2.29M-2.09M	2.29M-2.09M

WEIGHT*

Mass in running order.	2955kg	3005kg	3065kg	3115kg
Essential hab equip.	90kg	90kg	90kg	90kg
Max. user payload.	545kg	495kg	435kg	385kg
Max tech laden mass.	3500kg	3500kg	3500kg	3500kg

BODYWORK

Thickness: walls/floor/roof (mm)	31/41/31	31/41/31
Insulation: walls/floor/roof (mm)	25/30/25	25/30/25

SLEEPING AREA

No. of berths	6	6
Over cab bed.	2.04Mx1.40M	2.10Mx1.40M
Dinette bed.	2.10Mx1.20M-0.80M	2.10Mx1.20M-1.10M
Double bed.	2.10Mx1.40M	2.10Mx1.40M
Lifting bed	–	–
Bunk.	–	–
Along side beds.	–	–

OPTIONS**

	(kg)	(kg)	(kg)
● SE Pack - Blaupunkt Lucca Sat Nav, Fire retardant carpets, 5 year unlimited mileage warranty and an Adria Umbrella.	2	● Rear air spring AL-KO	12
● Tow bar and electrics	37	● ASR	2
● Paintseal body protection	50	● Motorbike holder	2,5
● DuPont Teflon fabric protection	3	● Spare wheel 15'	31
		● Spare wheel 16'	33
		● Air-condition	22
		● Front fog lamps	2
		● Codriver's air-bag	2,5
		● Cruise control	2
		● Stronger alternator	2
		● Webasto programable	3
		● Mud protection - front wheels	2
		● Alu wheels 15'	-6
		● Alu wheels 16'	-6

* denotes estimated

**not included in the mass in running order

A 690 DK

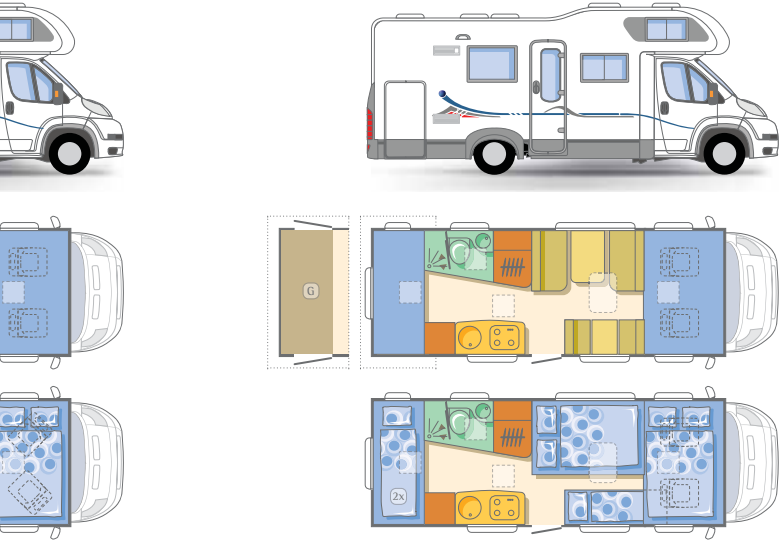

coral

A 690 DK

FIAT Ducato			
160 JTD (3,0)-40H 2999 157/115,5	130 JTD (2,3)-35L 2287 130/95,5	160 JTD (3,0)-35L 2999 157/115,5	160 JTD (3,0)-40H 2999 157/115,5
4.035			
6+RM			
Front Wheel			
225/75 R16	215/70 R15	215/70 R15	225/75 R16
60			
95			
4	3	2	6
7.29M			
2.29M			
3.12M	3.05M	3.05M	3.12M
4.78M			
2.18M			
2.29M-2.09M			
3155kg	3115kg	3165kg	3205kg
90kg	90kg	90kg	90kg
845kg	385kg	335kg	795kg
4000kg	3500kg	3500kg	4000kg
31/41/31			
25/30/25			
7			
2.10Mx1.40M			
1.90Mx1.38M, 1.36Mx0.60M			
-			
-			
2x(2.18Mx0.88M)			
-			



coral A 660 SP



coral A 660 SP

• standard o option – not provided

* denotes estimated
**not included in the mass in running order

▶ STANDARD EQUIPMENT

	A 640 SK	A 660 SP
NCC Inspected and approved motorhome	•	•
Thiefbeaters theft deterrent system	•	•
Blaupunkt San Remo radio / CD / MP3	•	•
Chassis extension	•	•
Corner steadies**	• (6kg)	• (6kg)
Awning light	•	•
Seitz windows with blinds and flyscreens	•	•
Seitz main entrance door	•	•
Roof light Midi Heki	•	2x
Roof light MINI HEKI	3x	2x
Roof light 400 x 400	•	•
Roof rack and ladder	•	•
Outside luggage box	•	2x
Refrigerator RM 7655 150 l Dometic (AES)	•	•
Refrigerator 104 l. el. Ignition	–	–
Spinflo oven with 4 burner hob and grill	–	–
Cramer 3 burner stainless steel hob	•	•
Cramer stainless steel sink	•	•
Extractor fan	•	•
Truma gas/electric heating and hot water	•	•
Ducted warm air heating to over cab beds	•	•
Ducted warm air heating in luggage space	•	•
Thetford CSW, turnable, electric pump	•	•
Separate shower cubicle	•	•
Solid shower door	•	•
Fresh water tank capacity (l)	50	50
Waste water tank capacity (l)	85	85
Shower tray	•	•
Shower faucet - separate	•	•
Electronic distribution panel	•	•
Leisure battery	85	85
Ceiling lights	•	•
Spot lights	•	•
Luggage box lights	•	•
Wardrobe light	•	•
Lifting bed in the cabin	–	–
Seat belts 2 x 3 + 2 x 2 points	–	–
Seat belts 2 x 3 points	•	•
Cushion formed 120 mm	•	•
Spring cushion in bedroom	–	•
Dedicated TV storage cabinet	•	•
TV antenna socket with coax cable	•	•
Wiring for additional radio speakers	•	•
Front seats in original textile colour	•	•
Comfort seats - turnable	•	•
Outside electrical entrance step	•	•
Gas oven Smev	•	•
Gas oven + grill	–	–
12 V waste water heater	•	•
Head restraints in oposite way of seat	–	–
Calori travel heater	•	•
Solar cells - preinstalations	•	•
Reverse driving sensor	•	•
Sattelite dish - preinstalations	•	•
Rear view camera - preinstalations	•	•
Air con. living space- preinstalations	•	•
Roof panoramic window Seitz	–	–
Remis curtain - windscreen	•	•

- kitchen
- table
- sitting group
- wardrobe
- berths
- bathroom
- floor
- G garage box

S 650 SP

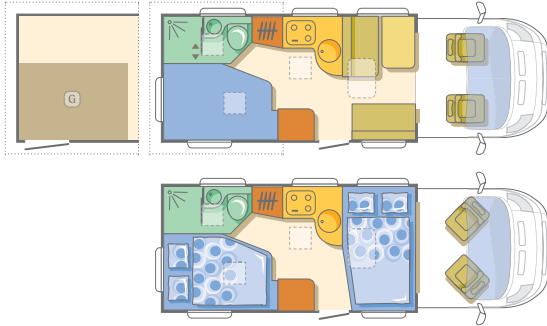
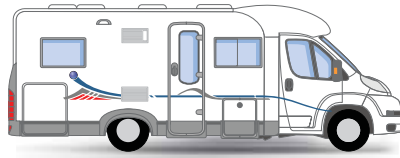

S 660 SL

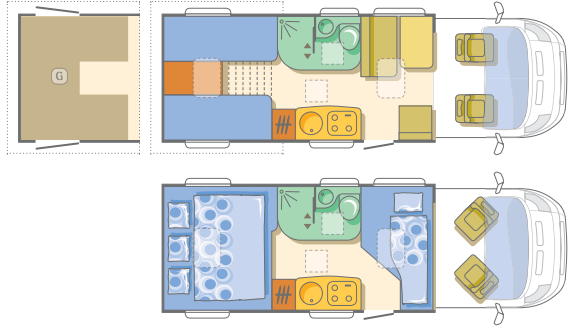

• standard o option – not provided

BASIC DATA ABOUT VEHICLE

	S 650 SP		S 660 SL	
	FIAT Ducato		FIAT Ducato	
Motor	130 JTD (2,3)-35L	160 JTD (3,0)-35L	130 JTD (2,3)-35L	160 JTD (3,0)-35H
Volume; HP / KW	2287 130/95,5	2999 157/115,5	2287 130/95,5	2999 157/115,5
Wheelbase	3.800		4.035	
Gears	6+RM		6+RM	
Drive	Front Wheel		Front Wheel	
Tyre dimensions	215/70 R15		215/70 R15	225/75 R16
Fuel tank (l)	90		90	
Battery (Ah)	95		95	
Homologated seats	4		4	

DIMENSIONS

Overall Length.	6.92M	7.23M
Overall Width.	2.29M	2.29M
Overall Height.	2.74M	2.78M 2.80M
Internal Length.	4.41M	4.73M
Internal Width.	2.18M	2.18M
Internal Height.	1.98M	1.98M

WEIGHT*

Mass in running order.	2820kg	2870kg	2835kg	2925kg
Essential hab equip.	144kg	144kg	144kg	144kg
Max. user payload.	680kg	630kg	665kg	575kg
Max tech laden mass.	3500kg	3500kg	3500kg	3500kg

BODYWORK

Thickness: walls/floor/roof (mm)	31/41/31	31/41/31
Insulation: walls/floor/roof (mm)	25/30/25	25/30/25

SLEEPING AREA

No. of berths	4	3+1
Over cab bed.	–	–
Dinette bed.	2.10Mx1.20M-1.10M	2.10Mx0.60M
Double bed.	1.98Mx1.32M	–
Lifting bed	–	–
Bunk.	–	–
Along side beds.	–	2.00Mx0.80M, 1.90Mx0.80M, + 1.90Mx0.58M

OPTIONS**

	(kg)		(kg)		(kg)
• SE Pack - Blaupunkt Lucca Sat Nav, Fire retardant carpets, 5 year unlimited mileage warranty and an Adria Umbrella.	2	• Rear air spring AL-KO	12	• Codriver's air-bag	2,5
• Tow bar and electrics	37	• ASR	2	• Cruise control	2
• Paintseal body protection	50	• Motorbike holder	2,5	• Stronger alternator	2
• DuPont Teflon fabric protection	3	• Spare wheel 15'	31	• Webasto programable	3
		• Spare wheel 16'	33	• Mud protection - front wheels	2
		• Air-condition	22	• Alu wheels 15'	-6
		• Front fog lamps	2	• Alu wheels 16'	-6

* denotes estimated

**not included in the mass in running order

S 680 SP

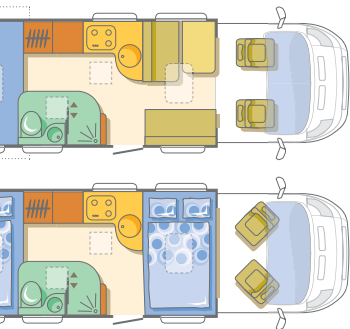

S 680 SPL

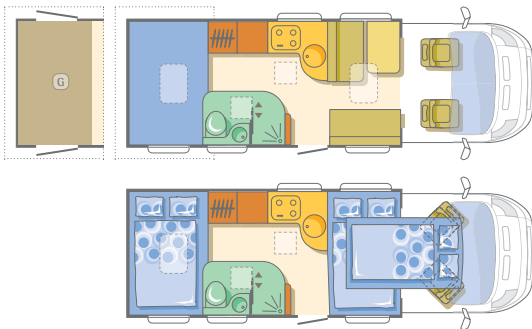

coral

S 680 SP

S 680 SPL

FIAT Ducato		FIAT Ducato	
130 JTD (2,3)-35L	160 JTD (3,0)-35L	130 JTD (2,3)-35L	160 JTD (3,0)-35L
2287	2999	2287	2999
130/95,5	157/115,5	130/95,5	157/115,5
4.035		4.035	
6+RM		6+RM	
Front Wheel		Front Wheel	
215/70 R15		215/70 R15	
90		90	
95		95	
4		4	
7.28M		7.28M	
2.29M		2.29M	
2.76M		2.76M	
4.77M		4.77M	
2.18M		2.18M	
1.98M		1.98M	
2880kg	2930kg	2940kg	2990kg
144kg	144kg	144kg	144kg
620kg	570kg	560kg	510kg
3500kg	3500kg	3500kg	3500kg
31/41/31		31/41/31	
25/30/25		25/30/25	
4		6	
—		—	
2.10Mx1.20M-1.10M		2.10Mx1.40M-1.26M	
2.10Mx1.40M		2.10Mx1.40M-1.26M	
—		1.84Mx1.20M	
—		—	
—		—	



coral S 680 SP



coral S 680 SP

• standard o option – not provided

* denotes estimated
**not included in the
mass in running order

▶ STANDARD EQUIPMENT

	S 650 SP	S 660 SL
NCC Inspected and approved motorhome	•	•
Thiefbeaters theft deterrent system	•	•
Blaupunkt San Remo radio / CD / MP3	•	•
Chassis extension	•	•
Corner steadies**	• (6kg)	• (6kg)
Awning light	•	•
Seitz windows with blinds and flyscreens	•	•
Seitz main entrance door	•	•
Roof light Midi Heki	•	2x
Roof light MINI HEKI	2x	•
Roof light 400 x 400	•	•
Roof rack and ladder	–	–
Outside luggage box	2x	•
Refrigerator RM 7655 150 l Dometic (AES)	•	–
Refrigerator 104 l. el. Ignition	–	•
Spinflo oven with 4 burner hob and grill	–	•
Cramer 3 burner stainless steel hob	•	•
Cramer stainless steel sink	•	•
Extractor fan	•	•
Truma gas/electric heating and hot water	•	•
Ducted warm air heating to over cab beds	–	–
Ducted warm air heating in luggage space	•	•
Thetford CSW, turnable, electric pump	•	•
Separate shower cubicle	•	•
Solid shower door	•	•
Fresh water tank capacity (l)	110	110
Waste water tank capacity (l)	85	85
Shower tray	•	•
Shower faucet - separate	•	•
Electronic distribution panel	•	•
Leisure battery	85	85
Ceiling lights	•	•
Spot lights	•	•
Luggage box lights	•	•
Wardrobe light	•	•
Lifting bed in the cabin	–	–
Seat belts 2 x 3 + 2 x 2 points	–	–
Seat belts 2 x 3 points	•	•
Cushion formed 120 mm	•	•
Spring cushion in bedroom	•	•
Dedicated TV storage cabinet	•	•
TV antenna socket with coax cable	•	•
Wiring for additional radio speakers	•	•
Front seats in original textile colour	•	•
Comfort seats - turnable	•	•
Outside electrical entrance step	–	–
Gas oven Smev	•	–
Gas oven + grill	–	•
12 V waste water heater	•	•
Head restraints in oposite way of seat	–	–
Calori travel heater	•	•
Solar cells - preinstalations	•	•
Reverse driving sensor	•	•
Sattelite dish - preinstalations	•	•
Rear view camera - preinstalations	•	•
Air con. living space- preinstalations	•	•
Roof panoramic window Seitz	o	o
Remis curtain - windscreen	•	•

- kitchen
- table
- sitting group
- wardrobe
- berths
- bathroom
- floor
- G garage box

A 576 DK

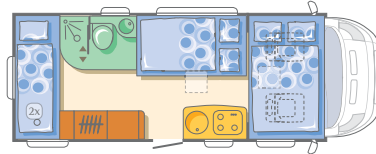
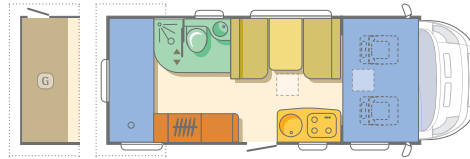

A 660 DP

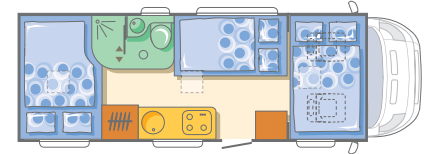
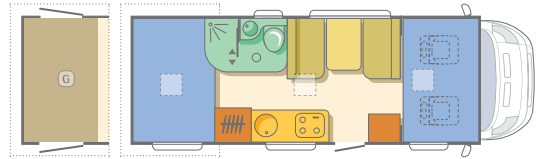
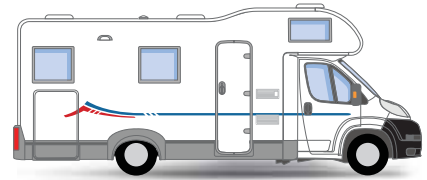

* denotes estimated

**not included in the mass in running order

• standard o option – not provided

	A 576 DK*		A 660 DP	
BASIC DATA ABOUT VEHICLE				
Vehicle	FIAT Ducato			
Motor	100 JTD (2,2)-35L	130 JTD (2,3)-35L	130 JTD (2,3)-35L	160 JTD (3,0)-35L
Volume; HP / KW	2198 100/74	2287 130/95,5	2287 130/95,5	2999 157/115,5
Wheelbase	3.800		4.035	
Gears	5+RM	6+RM	6+RM	
Drive	Front Wheel		Front Wheel	
Tyre dimensions	215/70 R15		215/70 R15	
Fuel tank (l)	60		60	
Battery (Ah)	95		95	
Homologated seats	5		5	5
DIMENSIONS				
Overall Length.	6.55M		7.23M	
Overall Width.	2.30M		2.33M	
Overall Height.	3.11M		3.07M	
Internal Length.	4.09M		4.70M	
Internal Width.	2.18M		2.18M	
Internal Height.	2.29M-2.09M		2.29M-2.09M	
WEIGHT*				
Mass in running order.	–	–	2935kg	2985kg
Essential hab equip.	–	–	90kg	90kg
Max. user payload.	–	–	565kg	515kg
Max tech laden mass.	3500kg	3500kg	3500kg	3500kg
BODYWORK				
Thickness: walls/floor/roof (mm)	31/41/31		31/41/31	
Insulation: walls/floor/roof (mm)	25/30/25		25/30/25	
SLEEPING AREA				
No. of berths	6		6	
Over cab bed.	2.10Mx1.40M		2.10Mx1.40M	
Dinette bed.	1.86Mx1.38M		1.90Mx1.38M	
Double bed.	–		2.10Mx1.45M-1.26M	
Bunk.	2x(2.18Mx0.78M)		–	

OPTIONS**	(kg)	(kg)	(kg)
● SE Pack - Blaupunkt Lucca Sat		● Rear air spring AL-KO	12
● Nav, Fire retardant carpets, 5 year unlimited mileage warranty and an Adria Umbrella.	2	● ASR	2
● Tow bar and electrics	45	● Motorbike holder	72
● Paintseal body protection	50	● Spare wheel 15"	31
● DuPont Teflon fabric protection	3	● Spare wheel 16"	33
		● Air-condition	22
		● Front fog lamps	2
		● Codriver's air-bag	2,5
		● Cruise control	2
		● Stronger alternator	2
		● Mud protection - front wheels	2
		● Alu wheels 15"	-6
		● Alu wheels 16"	-6

CC

S 573 DS

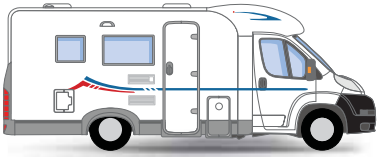

S 574 SP

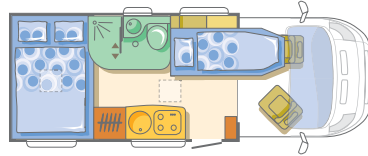
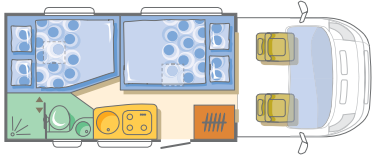
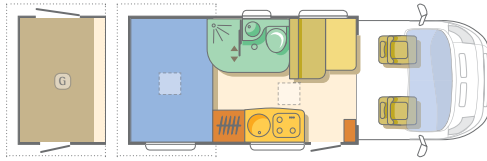
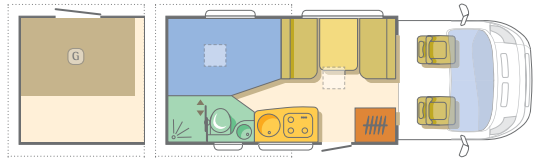

S 573 DS

S 574 SP

FIAT Ducato		FIAT Ducato	
100 JTD (2,2)-33L	130 JTD (2,3)-35H	100 JTD (2,2)-33L	130 JTD (2,3)-35L
2198 100/74	2287 130/95,5	2198 100/74	2287 130/95,5
3.800		3.450	
5+RM	6+RM	5+RM	6+RM
Front Wheel		Front Wheel	
215/70 R15	225/75 R16	215/70 R15	
90		90	
95		95	
6	5	4	
6.47M		6.43M	
2.33M		2.33M	
2.71M		2.71M	
4.00M		3.97M	
2.18M		2.18M	
1.98M		1.98M	
2585kg	2680kg	2610kg	2665kg
126kg	126kg	144kg	144kg
715kg	620kg	690kg	835kg
3300kg	3500kg	3300kg	3500kg
31/41/31		31/41/31	
25/30/25		25/30/25	
4		3	
-		-	
1.90Mx1.38M		1.80Mx1.00M-0.50M	
1.98Mx1.32M		2.10Mx1.45M-1.35M	
-		-	

coral sport



coral sport S 574 SP



coral sport S 574 SP

* denotes estimated
 **not included in the
 mass in running order

• standard ◦ option – not provided

▶ **STANDARD EQUIPMENT**

	A 576 DK*	A 660 DP
NCC Inspected and approved motorhome	•	•
Thiefbeaters theft deterrent system	•	•
Blaupunkt San Remo radio / CD / MP3	•	•
Chassis extension	•	•
Awning light	•	•
Double glazed windows with blinds and flyscreens	•	•
Entrance door Seitz without window	•	•
Roof light 400 x 400	2x	3x
Roof rack with ladder	•	•
Outside luggage box	•	•
Refrigerator N 180 L, Thetford	–	•
Refrigerator 88 L	•	–
Cramer 3 burner stainless steel hob	•	•
Stainless steel sink	•	•
Truma gas/electric hot water and heating	•	•
Ducted warm air to over cab beds	•	•
Ducted warm air to luggage spaces	•	•
Thetford CSW, turnable, electric pump	•	•
Separate shower cabin	•	•
Solid shower door	•	•
Fresh water tank capacity	90	90
Waste water tank capacity	85	85
Shower tray	•	•
Shower faucet - separate	•	•
Electronic distribution panel	•	•
Leisure battery	85	85
Ceiling lights	•	•
Spot lights	•	•
Seat belts 2 x 3 + 2 x 2 points	•	•
Seat belts 2 x 3 points	–	–
Cushion formed 120 mm	•	•
Dedicated TV storage cabinet	•	•
TV antenna socket with coax wiring	•	•
Comfort seats - turnable	–	–
Outside electrical entrance step	•	•
Head restraints in oposite way of seat	•	•

- kitchen
- table
- sitting group
- wardrobe
- berths
- bathroom
- floor
- G garage box

Adria TWIN

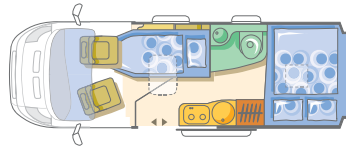
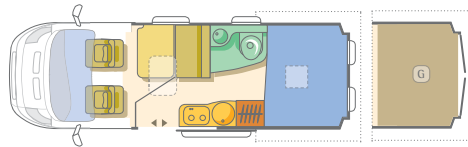
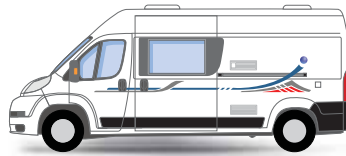

Adria VAN M

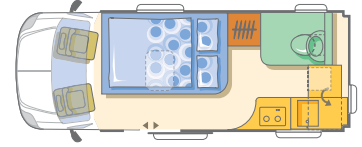
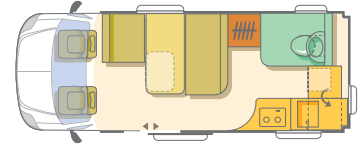
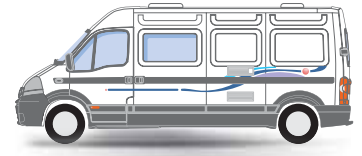

● standard ○ option – not provided

	Adria TWIN			Adria VAN M	
BASIC DATA ABOUT VEHICLE					
Vehicle	FIAT Ducato			Renault Master	
Motor	100 JTD (2,2-33L)	120 JTD (2,3-33L)	160 JTD (3,0-35H)	2.5 dCi 100	2.5 dCi 120
Volume; HP/KW	2198 100/74	2287 120/88	2999 157/115,5	2463 100/74	2463 115/88
Wheelbase	4.035			4.078	
Gears	5+RM	6+RM	6+RM	6+RM	
Drive	Front wheel			Front wheel	
Tyre dimensions	215/70 R15	215/70 R15	225/75 R16	225/65 R16	
Gas tank (l)	90			100	
Battery (Ah)	95			95	
Homologated seats	4			4	
DIMENSIONS					
Overall Length.	5.99M			5.90M	
Overall Width.	2.05M			1.99M	
Overall Height.	2.64M	2.64M	2.66M	2.60M	
Internal Length.	3.70M			3.67M	
Internal Width.	1.80M			1.73M	
Internal Height.	1.90M			1.88M	
WEIGHT*					
Mass in running order	2705kg	2720kg	2860kg	2780kg	2780kg
Essential habitation equipment	124kg	109kg	169kg	120kg	120kg
Max. user payload	595kg	580kg	640kg	720kg	720kg
Max. technical permissible laden mass	3300kg	3300kg	3500kg	3500kg	3500kg
BODYWORK					
Thickness: walls/floor/roof (mm)	20/21/18			–	
Insulation: walls/floor/roof (mm)	10/10/10			25/30/25	
SLEEPING AREA					
No. of berths	2+1			2	
Dinette bed.	1.30Mx0.94M			1.92M x 1.20M	
Lifting bed.	–			–	
Double bed.	1.96Mx1.45M-1.40M			–	

*Weights in line own weight and towing weight can differ +/- 5%

** Fiat - white vehicles as standard, other colours as option middle part black colour on all cars
Renault Master - white and metal grey - front middle part
Renault Traffic - all colours as option

*** Not included in the mass in running order

3 Way SPACE

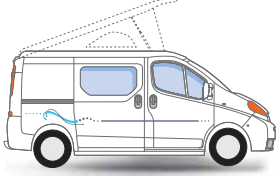

adria van

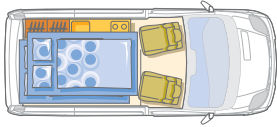
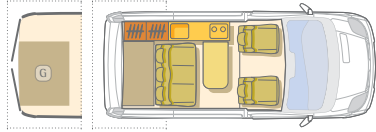

3 Way SPACE

Renault Traffic
2.0 dCi 115
1998 115 /84
3.098
6+RM
Front wheel
205/65 R16
90
95
5

4.78M
1.91M
1.99M
2.37M
1.64M
1.36M

2222kg
—
—
2700kg

—
—
4
1.90Mx1.30M
2.00Mx1.27M
—



Adria TWIN

OPTIONS***

(kg)

- SE Pack - Blaupunkt Lucca Sat Nav, Fire retardent carpets, 5 year unlimited mileage warranty and an Adria Umbrella. 2
- Tow bar and electrics 45
- Paintseal body protection 50
- DuPont Teflon fabric protection 3
- ASR 2
- Air-condition 23
- Front fog lamps 1
- Codriver's air-bag 4
- Cruise control 2
- Metallic colour 2
- Stronger alternator 2
- Webasto programable 6,5
- Mud protection - front wheels 2
- ESP 4
- Alu wheels 15' -10
- Alu wheels 16' -10

COLOURS RANGE

(kg)

- White - 249 0
- Blue blu line - 479 0
- Silver alluminium - 611 (metallic) 2
- Red "rosso profondo" - 255 (metallic) 2

Adria VAN M

OPTIONS***

(kg)

- SE Pack - Blaupunkt Lucca Sat Nav, Fire retardent carpets, 5 year unlimited mileage warranty and an Adria Umbrella. 2
- Tow bar and electrics 45
- Paintseal body protection 50
- DuPont Teflon fabric protection 3
- Airbag - coodriver 4
- Alarm system 3
- Manual aircondition 23
- Radio CD, 4x15 W RDS 2
- Front fog lamps 1
- Onboard computer 0,2
- Speed control - tempomat 2
- Satellite navigation system with radio CD 2
- Gear box quick shift (2,5 dCi 120) 15
- Ball coupling with holder, el. conn. 21
- Aluminium wheels -10

COLOURS RANGE

(kg)

- "Apacha" red (Optional Colour)
- Matalic grey - G64 (Optional Colour)
- Ancona metallic green - D92 (Optional Colour)
- Colibri blue metallic - J43 (Optional Colour)

3 Way SPACE

OPTIONS***

(kg)

- SE Pack - Blaupunkt Lucca Sat Nav, Fire retardent carpets, 5 year unlimited mileage warranty and an Adria Umbrella. 2
- Tow bar and electrics 45
- Paintseal body protection 50
- DuPont Teflon fabric protection 3
- Airbag - coodriver 4
- Alarm system 3
- Manual aircondition (+ heat refl. Windscreen) 23
- Front fog lamps 1
- Radio CD, 2x15W RDS, fingertip remote control 2
- Prewiring for telephone + radio CD 2x15W
- Satellite navigation system 2
- Ball coupling with holder, el. conn. 21
- Aluminium wheels -10
- Coloured shock bumpers **

COLOURS RANGE

(kg)

- White - D31 (Standard Colour)



3Way Space

*Euro version – UK van has steering wheel on the other side



adria Twin*



adria Twin*

*Weights in line own weight and towing weight can differ +/- 5%

- ** Fiat – white vehicles as standard, other colours as option middle part black colour on all cars
- Renault Master – white and metal grey – front middle part
- Renault Traffic – all colours as option

*** Not included in the mass in running order

- standard
- o option
- not provided

▶ EQUIPMENT

	Adria TWIN	Adria VAN M
NCC Inspected and approved motorhome	•	•
Thiefbeaters theft deterrent system	•	•
Blaupunkt San Remo radio / CD / MP3	•	•
Double glazed windows with blinds and flyscreens	•	•
Roof light Mini Heki	–	•
Roof light MIDI HEKI	2x	•
Refrigerator 70 L	•	•
Refrigerator Waeco 42 l compresor	–	–
2 burner hob + gas oven Smev 1002GT	•	•
2 burner hob	–	•
Sink - glass cover	•	•
Gas grill	•	–
Truma gas/electric hot water and heating	•	•
Thetford CSW, turnable, elctric pump	•	•
Fresh water tank capacity (l)	110	110
Waste water tank capacity (l)	90	95
Shower tray	•	•
Shower faucet	•	•
Control panel	•	•
Leisure battery	70	70
Ceiling lights	•	•
Spot lights	•	•
Luggage box light	–	–
Seat belts 2x 3 points	•	•
Seat belts 2 x 2 points + 2 x 3 points	–	–
Cushion formed 120 mm	•	•
Spring cushion in bedroom	•	–
TV antenna socket with coax wiring	•	•
Wire for loudspeakers	–	–
Comfort seat Isri	•	•
Front seat covering	–	•
Turnable codriver seat	•	•
Turnable driver seat	•	–
Outside electrical entrance step	•	•
Coloured bumpers **	•	•
Remis roller blind - front cabin window	•	•

adria van

3 Way SPACE

-
-
-
-
-
-
-
-
-
-
-
-
-
- 40
- 40
-
-
-
- 57
-
-
-
-
-
-
-
-
-
-
-
-
-



3Way Space



3Way Space



living in motion

ADRIA MOBIL, d.o.o.
Straška cesta 50,
8000 Novo mesto,
SLOVENIJA
Tel.: ++386(0)7 3937100
Fax: ++386(0)7 3937200
mail: info@adria-mobil.si
www.adria-mobil.com

Official representative:
Adria United Kingdom
Hall Street, Long Melford,
Suffolk, CO10 9JP
tel: 0044 (0)870 774 0007
fax: 0044 (0)870 774 3007



GB

Join Club Adria! The club that welcomes owners of all Adria products regardless of age or model - for more details contact The Secretary on 077886 17776.

The purpose of the catalogue is illustrative. Pictures inside catalogue may include some elements not belonging to standard equipment or portray products belonging to different markets. Products may change from technical or commercial points of view in respect of regulations. Please contact your selected Dealer to obtain detailed information before purchasing.

*Adria United Kingdom is the trading style of Adria Concessionaires Limited, whose registered office is Hall Street, Long Melford, Suffolk, CO10 9JP and is company registered in England, number 894586.

Published by: Adria Mobil, d.o.o.; Design and production: Enigma Novo mesto d.o.o., Brigita Jakovec; Photography: Arsis, archive Adria, Aleš Fevžer; Lythography: Data Com d.o.o.; Printed by: Gorenjski tisk

