

EN



# Concorde

REISEMOBILE AUS LEIDENSCHAFT



**CREDO CARVER**  
**CHARISMA CENTURION DAILY**  
UP TO 7.49 TONNES



# *Concorde*

REISEMOBILE AUS LEIDENSCHAFT

Credo, Carver, Charisma and Centurion Daily represent the broad luxury segment at Concorde.

Each of these series sets standards in terms of design, technology and comfort and serves a role model in its respective class across the industry. The expressive styling lends the vehicles an unmistakable appearance that clearly identifies them as Concorde.

They are all true to our motto "We are passionate about motorhomes" and are produced as handcrafted masterpieces by a dedicated staff with passion, enthusiasm and commitment on the basis of engineering expertise, design creativity and precision in production.

“WE ARE PASSIONATE  
ABOUT MOTORHOMES”  
FOR THE PAST 40 YEARS



Today's Concorde Reisemobile GmbH has its roots in the year 1981 and is one of the pioneers of German motorhome construction. Concorde has been based in Aschbach for 28 years and, thanks to a committed management team that has experience in the industry, has developed there into an attractive location with a highly modern motorhome production facility.

Each year, approximately 400 exclusive motorhomes are manufactured here using a precisely balanced combination of individual craftsmanship and high precision. Production takes place using a precisely balanced combination of individual craftsmanship and high precision and – in part computer-controlled technology.

Also referred to as "land yachts", these vehicles are absolute premium products full of innovation, precision and passion.





# CONTENTS

REFINED FEATURES	60
PASSION	62

<b>CREDO</b>	INTERIOR	8
	SERIES HIGHLIGHTS	14
	FLOOR PLAN	16

<b>CARVER</b>	INTERIOR	22
	SERIES HIGHLIGHTS	28
	FLOOR PLAN	30

<b>CHARISMA</b>	INTERIOR	36
	SERIES HIGHLIGHTS	42
	FLOOR PLAN	44

<b>CENTURION IVECO DAILY</b>	INTERIOR	48
	SERIES HIGHLIGHTS	54
	FLOOR PLAN	56



# CREDO GET INTO THE CONCORDE CLASS





Traditionally, the Concorde experience begins with the Credo at the entry-level to the Concorde class. In addition to the four existing models we have extended the Credo range with four new floor layouts, redefining this series and once again setting the standard in this class with numerous innovations.

As you can see the new Credo is at first glance a true Concorde. The large bus mirrors and windscreen wipers, in combination with the optional exterior design in Centurion Style are clear components of the Concorde DNA. A new highlight in the Credo are the frameless flush fitting side windows in the driver's cab area.



CREDO

CARVER

CHARISMA

CENTURION



CREDO 740 HI

# CONCORDE DNA - VISIBLE AT FIRST GLANCE

Of course, our motorhomes also impress at a second glance. Take the living area in the Concorde Credo, for example. A bright, friendly environment where its decor, upholstery and carpet fabrics are in perfect coordination with the furniture, with doors and flaps veneered in Ebano silver. The new interior locking system is discreetly arranged and underlines the exclusive overall impression of the furniture. The alternating convex and concave surfaces and the "Concorde One Level Floor Concept" create a effect of space from the driver's cabin to the bedroom.

The kitchen in the new Credo is also a clear commitment to quality and function. With the three-burner hob, the single-lever mixer water tap, the perfectly integrated sink, the bin for kitchen waste and the neat socket strip, the open kitchen in the Credo models sets standards in its class in terms of ergonomics, design and function.



Learn about the large selection of furniture front panels and seating group variants with their leathers and fabrics.

CREDO 841 L



CREDO

CARVER

CHARISMA

CENTURION

# REFRESHED AND RELAXED INTO THE NEW DAY

Do you like to start the new day refreshed and relaxed? Nothing could be easier. In the spacious bathroom of the new Concorde Credo models, a large amount of space is the trump card. In the twinkling of an eye, by closing the doors to the living room and bedroom, the separate shower and toilet room becomes one large bathroom and dressing room.

Our development team have created a wellness oasis to help you wind down and relax in our Bedroom area of the new Concorde Credo models. In addition to the generous bed dimensions, there is also the "Concorde Comfort Plus Bed System": A perfect combination of slatted frame and Evopore HRC comfort foam mattress with water gel core, enabling a truly relaxing and restful sleep.

CREDO 740 HI





CREDO 841 L



CREDO 740 HI

CREDO

CARVER

CHARISMA

CENTURION

# THE SERIES

The wellness oasis with separate toilet room offers them a spacious area for their personal refreshment. Two doors separate it from the bedroom and living room.



A remote control, which is integrated in the ignition key of the basic vehicle, automatically locks and unlocks the entrance door.



# HIGHLIGHTS

The coach-style rear-view mirrors, which are elegant and ensure optimum visibility, increase active safety while driving and, above all, when manoeuvring.



The steering wheel, which is easy to remove and attach, provides a significant increase in comfort, freedom of movement and safety with its functionality optimised by Concorde.



Here you can see all the highlights of the Credo series.

CREDO

CARVER

CHARISMA

CENTURION

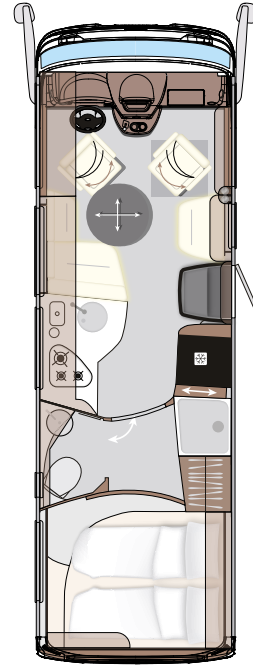

## CREDO 740 HI

BASIC VEHICLE	Iveco Daily
CHASSIS TYPE	50C16
ENGINE (Euro VI e)	4-cylinder
ENGINE CAPACITY	2,3 l
OUTPUT	115 kW (156 hp)
TORQUE	380 Nm
OVERALL LENGTH (mm)	7490
OVERALL WIDTH (mm)	2330
OVERALL HEIGHT (mm)	3210
WHEEL BASE (mm)	3850
MAXIMUM TECHNICALLY-AUTHORISED GROSS VEHICLE WEIGHT (kg)	5200
MASS IN RUNNING ORDER (kg)	4085
PAYLOAD (kg)	1115
TRAILER LOAD BRAKED (kg)	3500
SEATS WITH THREE-POINT SEATBELT	2 / 3 / 4



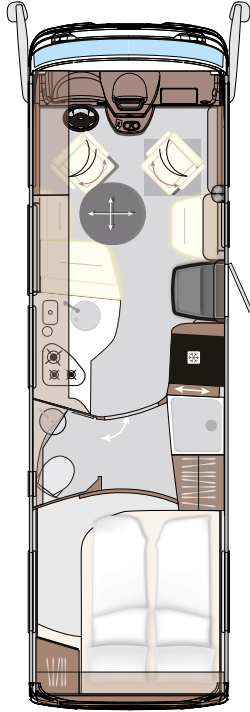

### CREDO 790 FI

Iveco Daily  
 50C16  
 4-cylinder  
 2,3 l  
 115 kW (156 hp)  
 380 Nm  
 7990  
 2330  
 3210  
 4100  
 5200  
 4185  
 1015  
 3500  
 2 / 3 / 4

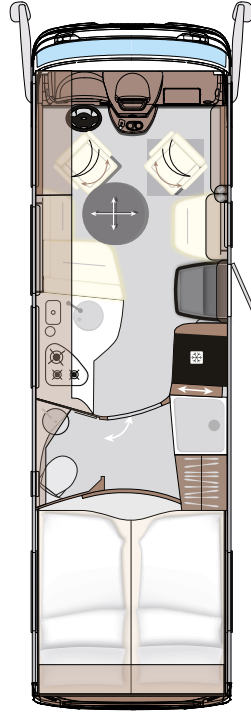

### CREDO 790 LI

Iveco Daily  
 50C16  
 4-cylinder  
 2,3 l  
 115 kW (156 hp)  
 380 Nm  
 7990  
 2330  
 3210  
 4100  
 5200  
 4185  
 1015  
 3500  
 2 / 3 / 4

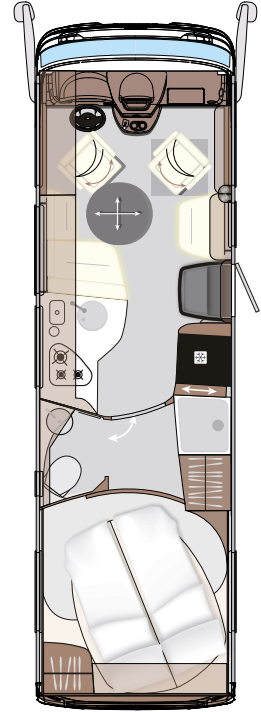

### CREDO 790 MI

Iveco Daily  
 50C16  
 4-cylinder  
 2,3 l  
 115 kW (156 hp)  
 380 Nm  
 7990  
 2330  
 3210  
 4100  
 5200  
 4185  
 1015  
 3500  
 2 / 3 / 4

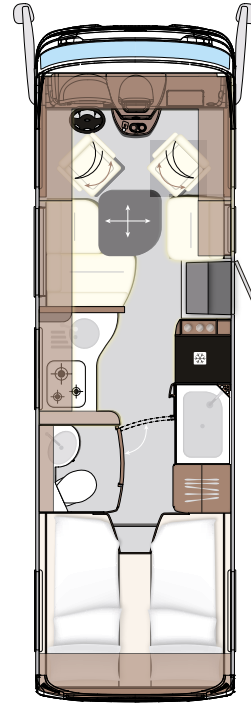

## CREDO 791 L

BASIC VEHICLE	Iveco Daily
CHASSIS TYPE	50C16
ENGINE (Euro VI e)	4-cylinder
ENGINE CAPACITY	2,3 l
OUTPUT	115 kW (156 hp)
TORQUE	380 Nm
OVERALL LENGTH (mm)	7990
OVERALL WIDTH (mm)	2330
OVERALL HEIGHT (mm)	3210
WHEEL BASE (mm)	4100
MAXIMUM TECHNICALLY-AUTHORISED GROSS VEHICLE WEIGHT (kg)	5200
MASS IN RUNNING ORDER (kg)	4050
PAYLOAD (kg)	1150
TRAILER LOAD BRAKED (kg)	3500
SEATS WITH THREE-POINT SEATBELT	2 / 3 / 4

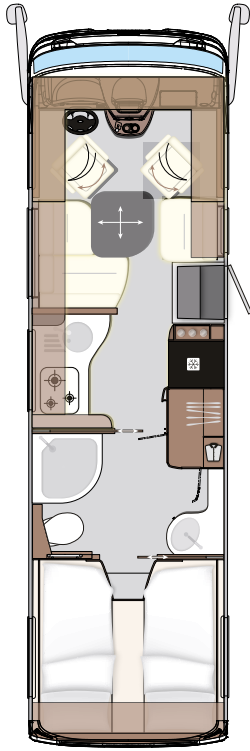

### CREDO 840 L

Iveco Daily  
 50C16  
 4-cylinder  
 2,3 l  
 115 kW (156 hp)  
 380 Nm  
 8490  
 2330  
 3210  
 4500  
 5200  
 4155  
 1045  
 3500  
 2 / 3 / 4

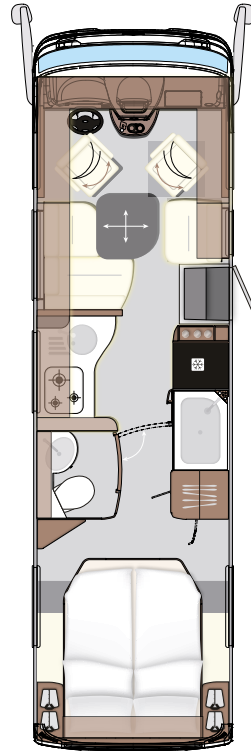

### CREDO 841 M

Iveco Daily  
 50C16  
 4-cylinder  
 2,3 l  
 115 kW (156 hp)  
 380 Nm  
 8490  
 2330  
 3210  
 4500  
 5200  
 4155  
 1045  
 3500  
 2 / 3 / 4

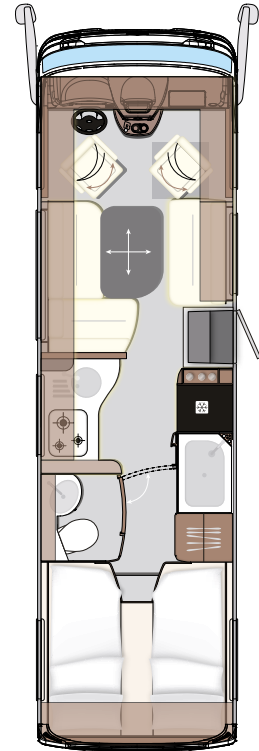

### CREDO 841 L

Iveco Daily  
 50C16  
 4-cylinder  
 2,3 l  
 115 kW (156 hp)  
 380 Nm  
 8490  
 2330  
 3210  
 4500  
 5200  
 4155  
 1045  
 3500  
 2 / 3 / 4



CREDO

Concorde



CONCORDE

CREDO



CREDO

CARVER

CHARISMA

CENTURION

# CARVER LUXURY MADE EASY



The Carver makes mobile luxury easy.

With its Concorde-typical exterior design, the Carver visually conveys a certain lightness in spite of its voluminous appearance. In fact, the Carver reduces its weight through the intelligent use of materials. Despite its material lightness, the vehicle features a plethora of innovative technology, tried-and-tested functionality and a high degree of winter hardiness.



CREDO

CARVER

CHARISMA

CENTURION

# STYLISH AND FUNCTIONAL

The kitchen is among the highlights of the Carver. The ergonomic kitchen ensemble with mineral kitchen worktop, stainless-steel hob and stainless-steel sink as well as the typical household accessories has been thought out by us down to the last detail and is combined with optimum room usage and exemplary equipment.

The living room provides a perfect combination of functionality and comfort with ergonomically shaped seating group and a lightweight furniture concept with a range of design variants.



Learn about the large selection of furniture front panels and seating group variants with their leathers and fabrics.





CARVER 890 RRL



CREDO

CARVER 790 L, EBANO SILVER MODEL OVERHEAD CABINET



CARVER

CHARISMA

CENTURION



CARVER 790 L



CARVER 890 RRL

# OASES OF WELL-BEING AND RELAXATION

Not only the Carver has a smart appearance, so too do its owners. Ensuring this is the spacious bathroom with its separate shower, toilet, washbasin, numerous storage areas as well as a large wardrobe. Hygiene, cleanliness and visible care are apparent not only in the "all-round" mirrors.

For external care of the body to continue, the sleeping area offers maximum comfort. A special spring base, comfortable cold-foam mattresses as well as cushioned headrests ensure relaxing and restful sleep.



CARVER 890 RRL

CREDO

CARVER

CHARISMA

CENTURION

# THE SERIES

Two aluminium frames in the Charisma's double floor ensure an extremely stable "basement construction" by connecting the auxiliary frame with the living area floor, creating a solid box. This clever construction means that furniture and wall constructions remain firmly connected in the long run.



Even mobile homes need a sound foundation. This is ensured by sturdy machine screws that sturdily secure the bottom floor of the chassis.



# HIGHLIGHTS

The elegant and functional aluminium front blind provides the required privacy and protects against unwanted sunlight.



The heated double floor with substantial interior height offers a generous amount of storage space and is easily accessible through the large storage space flaps, which can be rotated by 180°.



Here you can see all highlights of the Carver series.

CREDO

CARVER

CHARISMA

CENTURION

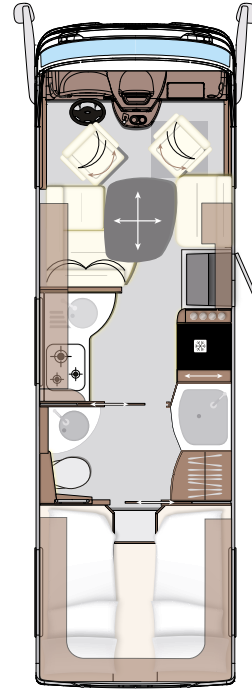

## CARVER 790 L

BASIC VEHICLE	Iveco Daily
CHASSIS TYPE	65C18
ENGINE (Euro VI e)	4-cylinder
ENGINE CAPACITY	3,0 l
OUTPUT	132 kW (180 hp)
TORQUE	430 Nm
OVERALL LENGTH (mm)	7990
OVERALL WIDTH (mm)	2400
OVERALL HEIGHT (mm)	3460
WHEEL BASE (mm)	4350
MAXIMUM TECHNICALLY-AUTHORISED GROSS VEHICLE WEIGHT (kg)	6500
MASS IN RUNNING ORDER (kg)	5230
PAYLOAD (kg)	1270
TRAILER LOAD BRAKED (kg)	3500
SEATS WITH THREE-POINT SEATBELT	3 / 4

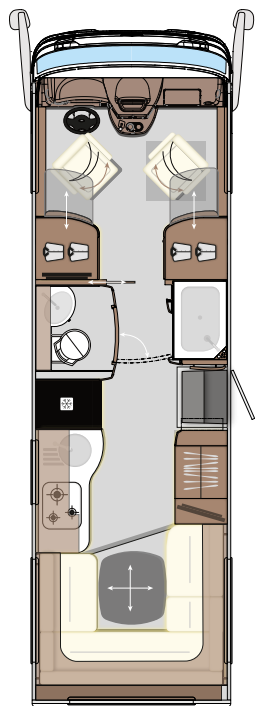

## CARVER 791 RL

Iveco Daily  
 65C18  
 4-cylinder  
 3,0 l  
 132 kW (180 hp)  
 430 Nm  
 8085  
 2400  
 3460  
 4350  
 6500  
 5180  
 1320  
 3500  
 2 / 4

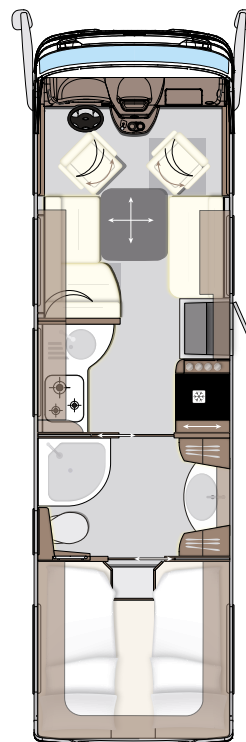

## CARVER 850 L

Iveco Daily  
 65C18  
 4-cylinder  
 3,0 l  
 132 kW (180 hp)  
 430 Nm  
 8590  
 2400  
 3460  
 4750  
 6500  
 5280  
 1220  
 3500  
 3 / 4

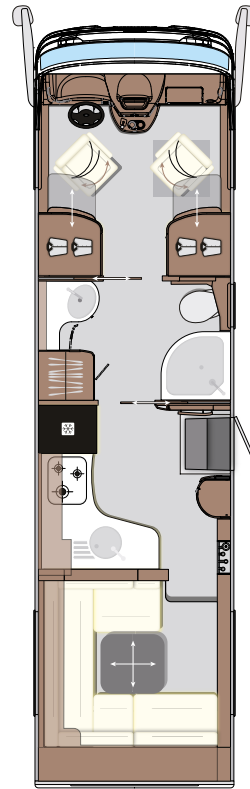

## CARVER 890 RRL

BASIC VEHICLE	Iveco Daily
CHASSIS TYPE	70C18
ENGINE (Euro VI e)	4-cylinder
ENGINE CAPACITY	3,0 l
OUTPUT	132 kW (180 hp)
TORQUE	430 Nm
OVERALL LENGTH (mm)	9085
OVERALL WIDTH (mm)	2400
OVERALL HEIGHT (mm)	3460
WHEEL BASE (mm)	5100
MAXIMUM TECHNICALLY-AUTHORISED GROSS VEHICLE WEIGHT (kg)	7200
MASS IN RUNNING ORDER (kg)	5445
PAYLOAD (kg)	1755
TRAILER LOAD BRAKED (kg)	3300
SEATS WITH THREE-POINT SEATBELT	2 / 4



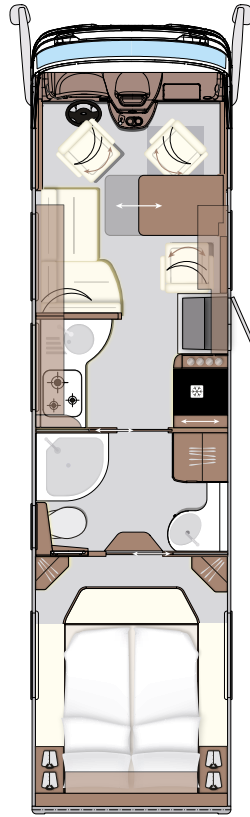

## CARVER 920 G

Iveco Daily

70C18

4-cylinder

3,0 l

132 kW (180 hp)

430 Nm

9450

2400

3460

5100

7490

5585

1905

2500

3 / 4





CARVER

CREDO

CARVER

CHARISMA

CENTURION

# CHARISMA THE CLASSIC



The classic among the land yachts.

The Charisma stands for all of the values Concorde represents with its company philosophy: innovation, quality and passion. Demonstrated by state-of-the-art and innovative vehicle technology, luxurious and practically oriented equipment as well as artisanal passion and material quality.

The current generation embodies progressive design, intelligent technology and uncompromising comfort and is a leader in style and exemplary for luxury motorhomes, also known as land yachts.



CREDO

CARVER

**CHARISMA**

CENTURION



# LIVING ENVIRONMENT AND KITCHEN STU

The living room as a living environment. Depending on the model: with bar version or a fifth seating place as a generously dimensioned lounge version, equipped to a high standard and unbelievably comfortable. The integrable driver's seat and passenger's seat offer additional living space.

The kitchen – a studio par excellence. Extendable pull-out pantries with plenty of storage space. High-quality kitchen appliances, a spacious refrigerator, the stainless-steel hob and integrated stainless-steel sink in the ergonomic mineral worktop convey a kitchen studio atmosphere.



Learn about the large selection of furniture front panels and seating group variants with their leathers and fabrics.



CREDO

CARVER

CHARISMA

CENTURION

# WELLNESS OASIS AND RELAXATION CENTRE

The bathroom – a wellness oasis! Tastefully furnished, it spans the entire width of the vehicle and has a spacious feeling. High-quality stainless-steel fittings, sink and shower basin made of artificial stone convey an exclusive wellness atmosphere.

The bedroom – a centre of relaxation! The high-quality Concorde sleep system with deluxe mattress and sturdy spring base ensures maximum comfort; the substantial bed dimensions provide a feeling of total relaxation.







CREDO

CARVER

CHARISMA

CENTURION

# THE SERIES

Storage space „en masse“, every corner wisely used. To create so many drawers, cabinet and storage spaces in such a limited space is a logistical masterpiece.



The comfortable two-zone underfloor heating is supported by a separate heating pump and can also be expanded to two zones on request.



# HIGHLIGHTS

The dashboard is ergonomically designed so that the driver always has the essential vehicle data in sight and can easily reach all function switches and levers.



The double floor offers twice the through-loading capacity over the entire vehicle width, for skis, surfboards or other boards and bulky objects in general.



Here you can see all highlights of the Charisma series.

CREDO

CARVER

**CHARISMA**

CENTURION

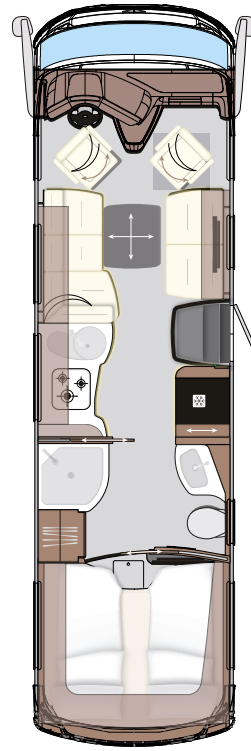

## CHARISMA 860 LI

BASIC VEHICLE	Iveco Daily
CHASSIS TYPE	65C18
ENGINE (Euro VI e)	4-cylinder
ENGINE CAPACITY	3,0 l
OUTPUT	132 kW (180 hp)
TORQUE	430 Nm
OVERALL LENGTH (mm)	8770
OVERALL WIDTH (mm)	2430
OVERALL HEIGHT (mm)	3540
WHEEL BASE (mm)	4750
MAXIMUM TECHNICALLY-AUTHORISED GROSS VEHICLE WEIGHT (kg)	6500
MASS IN RUNNING ORDER (kg)	5465
PAYLOAD (kg)	1035
TRAILER LOAD BRAKED (kg)	3500
SEATS WITH THREE-POINT SEATBELT	3 / 4 / 4 / 5

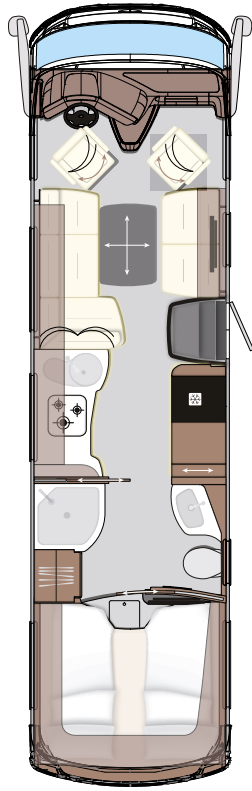

## CHARISMA 910 LI

Iveco Daily  
 65C18  
 4-cylinder  
 3,0 l  
 132 kW (180 hp)  
 430 Nm  
 9270  
 2430  
 3540  
 4900  
 6500  
 5675  
 825  
 3500  
 3 / 4 / 4 / 5

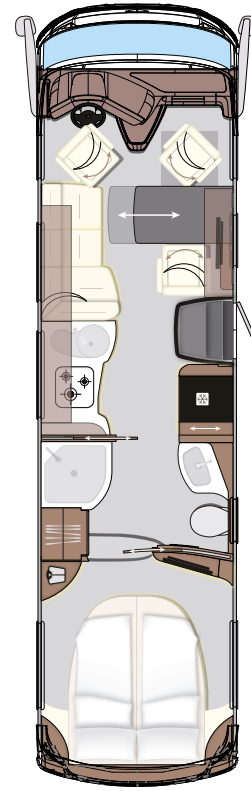

## CHARISMA 910 MI

Iveco Daily  
 65C18  
 4-cylinder  
 3,0 l  
 132 kW (180 hp)  
 430 Nm  
 9270  
 2430  
 3540  
 4900  
 6500  
 5675  
 825  
 3500  
 3 / 4 / 4 / 5



CHARISMA

Concorde



CONCORDE

powered by **W800**



CHARISMA

CREDO

CARVER

CHARISMA

CENTURION

# COMPACT CENTURION ON IVECO DAILY





The compact member of the Centurion series – with a gross vehicle weight of less than 7.5 tonnes – makes a big impression.

Equipped with luxurious innovations that have already proven themselves on its big brother, this Daily-based Centurion combines an absolute maximum of luxury and comfort.



CREDO

CARVER

CHARISMA

CENTURION

# LARGE INTERIOR SIZE THANKS TO LIMITLESS CREATIVITY

The generously dimensioned and well-equipped living environment creates an enormous spatial impression thanks to discreetly placed ambient lighting as well as two large windows that extend into the kitchen.

The kitchen shines with electromechanical coffee machine lift, retractable socket strip, integrated double sink and hybrid ceramic hob. Everything is functional and styled to preserve the spacious room feeling.





CREDO

CARVER

CHARISMA

**CENTURION**



# 5-STAR BATHROOM AND BEDROOM

The bathroom with its high-quality fittings, large rainforest shower, plentiful drawers and mirrors as well as generously equipped washbasin creates a 5-star atmosphere.

The same applies to the bedroom, which, with comfortable mattress, generously dimensioned lying surface as well as stylish lighting of the canopy around the circumferential overhead cabinet, provides a perfect sleep arena.



CREDO

CARVER

CHARISMA

CENTURION

# THE SERIES

The Centurion is well supplied with power thanks to a 24-volt bus system with powerful lithium batteries – everything securely installed and wired.



Elegant and robust bus skirting support the exterior design and automotive shape and give the entire body and the individual flaps a secure hold.



# HIGHLIGHTS



The indirect lighting integrated in the roof trim provides pleasant illumination. The all-round lighting makes night-time manoeuvring easier and improves safety.



The flaps are opened via the Concorde aluminium hinge with rubber core. Thanks to this intelligent solution, no water runs through between the side wall and the flaps even when they are open.



Here you can see all highlights of the Centurion Daily series.

CREDO

CARVER

CHARISMA

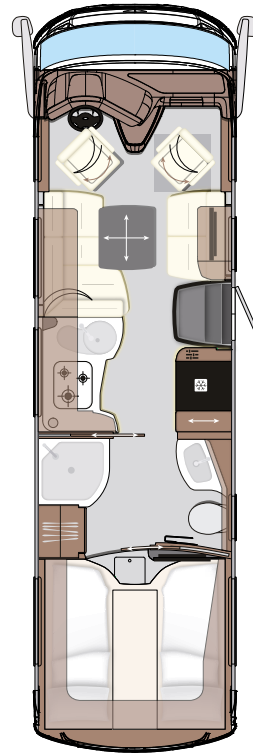

## CENTURION 860 LI

BASIC VEHICLE	Iveco Daily
CHASSIS TYPE	70C21
ENGINE (Euro VI e)	4-cylinder
ENGINE CAPACITY	3,0 l
OUTPUT	154 kW (210 hp)
TORQUE	470 Nm
OVERALL LENGTH (mm)	8770
OVERALL WIDTH (mm)	2430
OVERALL HEIGHT (mm)	3540
WHEEL BASE (mm)	4750
MAXIMUM TECHNICALLY-AUTHORISED GROSS VEHICLE WEIGHT (kg)	7490
MASS IN RUNNING ORDER (kg)	5750
PAYLOAD (kg)	1740
TRAILER LOAD BRAKED (kg)	3000
SEATS WITH THREE-POINT SEATBELT	3 / 4



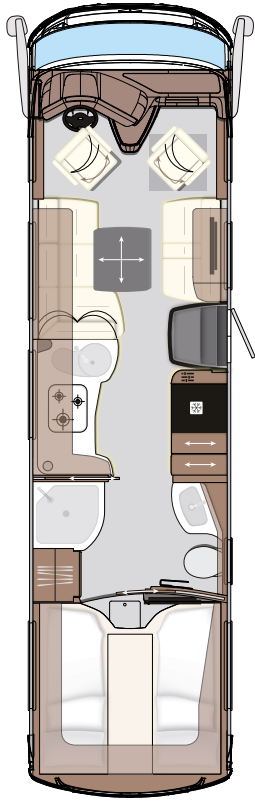

## CENTURION 910 LI

Iveco Daily  
 70C21  
 4-cylinder  
 3,0 l  
 154 kW (210 hp)  
 470 Nm  
 9270  
 2430  
 3540  
 4900  
 7490  
 5870  
 1620  
 3000  
 3 / 4 / 5

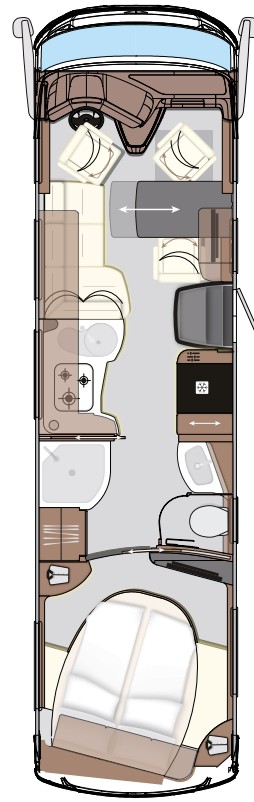

## CENTURION 910 MI

Iveco Daily  
 70C21  
 4-cylinder  
 3,0 l  
 154 kW (210 hp)  
 470 Nm  
 9270  
 2430  
 3540  
 4900  
 7490  
 5870  
 1620  
 3000  
 3 / 4

CREDO

CARVER

CHARISMA

CENTURION





CENTURION

CREDO

CARVER

CHARISMA

CENTURION



DESIGN  
CONCEPTS



LEATHER AND  
FABRICS



# FEATURES



SIMPLY  
INGENIOUS



SIMPLY  
INGENIOUS





# WE ARE PASSIONATE ABOUT MOTORHOMES.

Concorde is committed to thinking like a manufacturer. We manufacture motorhomes of the highest quality for the highest demands. Every vehicle is unique, an individual masterpiece, classically hand-crafted by a traditional Franconian company, with unwavering passion, enthusiasm and inspiration. Because a passion for motorhomes is what unites the people at Concorde. And it is that which unites us with you.





# Concorde

REISEMOBILE AUS LEIDENSCHAFT



Concorde Reisemobile GmbH  
Concorde-Straße 2-4 · D-96132 Schlüsselfeld-Aschbach (Germany)  
Phone +49 (0) 9555 9225-0 · Fax +49 (0) 9555 9225-44  
Internet: [www.concorde.eu](http://www.concorde.eu) · E-mail: [info@concorde.eu](mailto:info@concorde.eu)

All information and figures apply for Concorde motorhomes from model year 2023. Model programmes, technical data and equipment features can differ from country to country. The design is based on StVO (German Road Traffic Act) and StVZO (German Road Traffic Licensing Regulations). We reserve the right to make changes, even without advance notice. Your Concorde dealer would be happy to give you current information. Please note that vehicles with special equipment are pictured which can deviate from the scope of delivery and standard equipment.